

The background of the page is filled with a repeating pattern of hand-drawn, sketch-style perfume bottles. Each bottle is rectangular with a faceted base and a simple, cylindrical cap with a small dropper tip. The drawings are light gray and scattered across the white background.

PÀSSIONEBEAUTY

PREPARATION AND
APPLICATION OF BUILDER GEL



Preparation without a nail drill

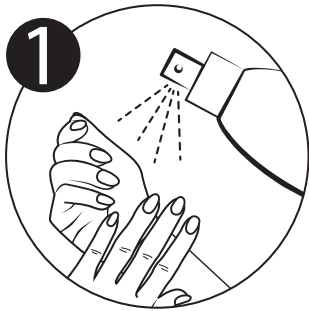

Spray **Fresh & Pure** onto hands and nails and allow to air dry.



Trim the free edge of the nail with a file.

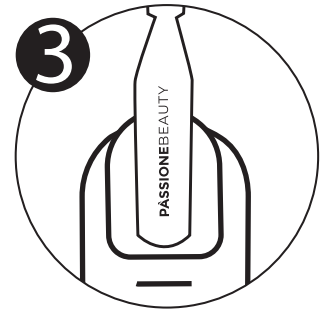

Gently push back the cuticles with the specially designed **Orangewood Sticks** or **Cuticle Pusher**.

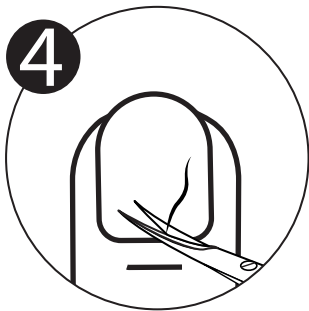

Remove cuticles with nail scissors.



Buff the surface of the natural nail using the **Preparation File Zebra Premium 180/240**.



Use **Nail Brush** to remove all dust from the surface.



Spray **Fresh & Pure**.

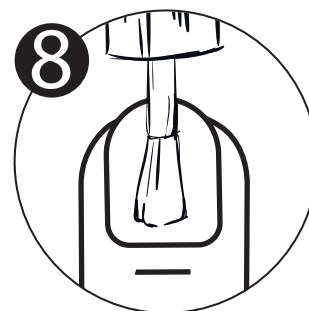

Apply **Nail Prep** and then **Binder** to the entire natural nail surface and allow to air dry. **In case of difficult nails, proceed by applying Primer on top of Nail Prep, followed by Binder, taking care not to touch the cuticle.** Allow preparatory liquids to air dry.

NOTE. APPLY BINDER AND PRIMER TO THE NATURAL NAIL ONLY, EVEN WHEN DOING REFILLS.

Preparation with a nail drill – Russian Manicure



Spray **Fresh & Pure** onto hands and nails and allow to air dry.

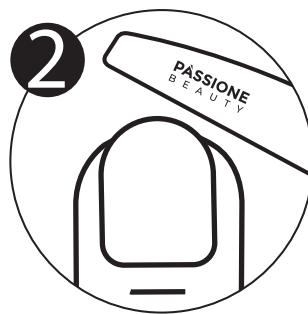

Trim the free edge of the nail with a file.

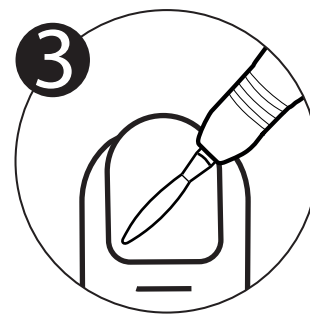

Use a flame-shaped diamond drill bit such as the **Dry Diamond Flame Nail Drill Bit Medium** to lift the cuticle from the nail bed.

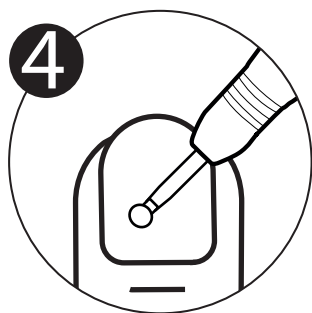

After that, use a round diamond drill bit such as the **Dry Diamond Ball Nail Drill Bit** to remove even the driest of cuticles without using nail scissors and to smooth down any thickening of the skin.



Go over the cuticle area to remove any residue, possibly using the **Ball Stone Nail Drill Bit** pumice stone tip.



Use **Nail Brush** to remove all dust from the surface.



Spray **Fresh & Pure**.

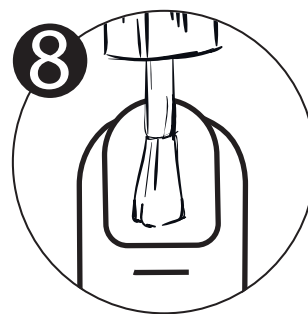

Apply **Nail Prep** and then **Binder** to the entire natural nail surface and allow to air dry. **In case of difficult nails, proceed by applying Primer on top of Nail Prep, followed by Binder, taking care not to touch the cuticle.** Allow preparatory liquids to air dry.

NOTE. APPLY BINDER AND PRIMER TO THE NATURAL NAIL ONLY, EVEN WHEN DOING REFILLS.

Applying a base coat

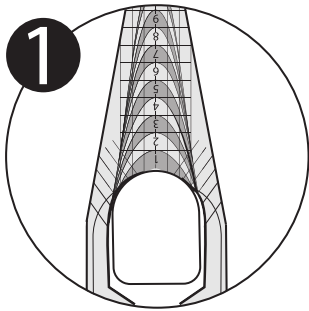

1 Cut out and position the **Nail Form** so that it follows the shape of the Eponychium and there is no gap between the nail and the form. Close the Nail Form to create the desired shape, ensuring that the lower wings stick together perfectly.

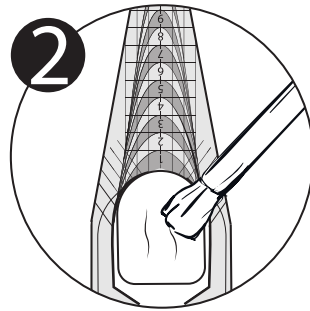

2 Apply a very thin and even layer of **Base coat** suitable for the application of a builder gel, as indicated in the product information. Apply the product on the nail using **Trendy Base Brush**, making sure to cover also the area between the natural nail and the paper in order to set it in place.



3 Cure the product for **30 seconds under a UV/LED lamp** or **120 seconds under a UV lamp**.

WHAT NOT TO DO

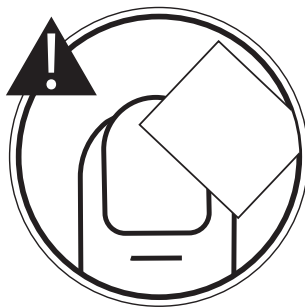

The tacky inhibition layer of the base coat should not be removed after curing.

Applying a builder gel



Take a small amount of product with **Trendy Brush Gel N.4** or **Trendy Oval Brush**, or, if using a builder gel with high viscosity, **Trendy Brush Gel N.6**.

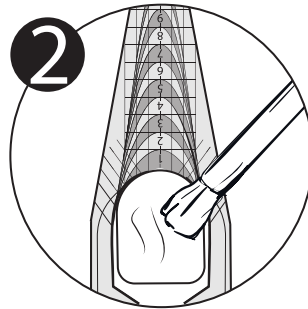

Apply a **thin slip layer** to the entire surface of the natural nail. **Do not cure.**



Take a **larger amount of product**.

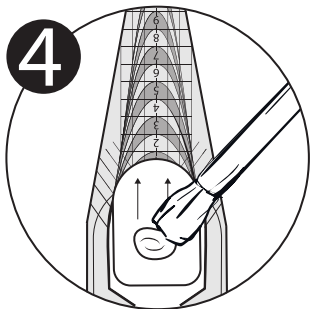

Create the **extension**: place the bead of product at the tip of the natural nail and work the product out to the desired length using light, gentle movements.



Cure for **15 seconds under a UV/LED lamp**, then pinch the nail and complete the curing process with 45 seconds under a UV/LED lamp.



Take a larger bead of product.

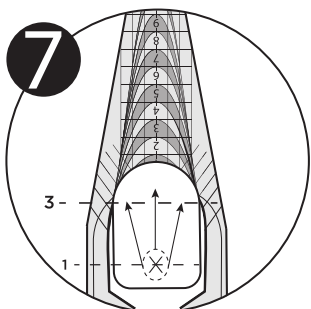

Create the **apex**: place the bead 1/3 of the way up the natural nail, push the product back towards the cuticle, then work the product out towards the length, without moving the apex of the nail.

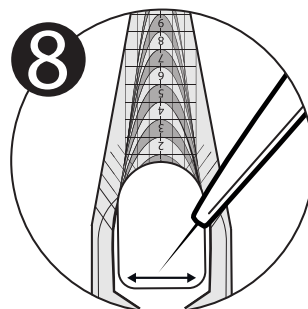

If necessary, define the structure and cuticle area using the **Trendy Brush Super Fine**.



Cure under a UV or UV/LED lamp for the time indicated on the label or on the product information.

Applying a builder gel

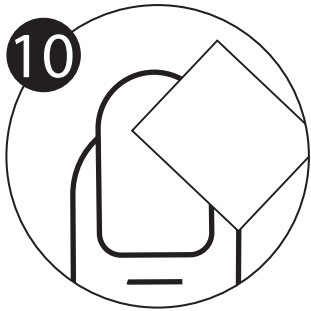

Vigorously **remove the tacky inhibition layer using the Cleaner.**

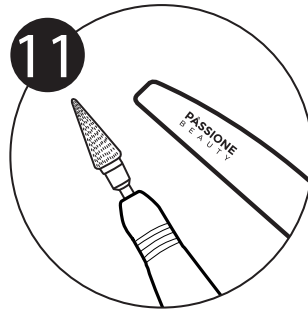

In the event of any imperfections in the application, file the nail structure using the **Precision File 180/240.**

If you prefer to use a nail drill for filing, we recommend a conical, medium-abrasion tungsten carbide bit such as the **Carbide Refill Hard Bit.**

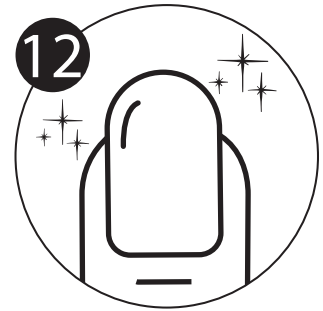

Proceed applying a **gel colour, gel polish or finish and cure.** Remove the inhibition layer from the top coat if needed.

Applying a builder gel

WHAT NOT TO DO

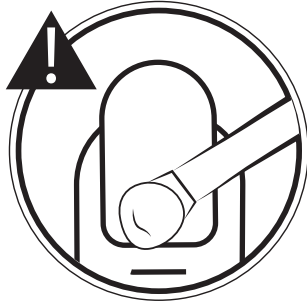

Apply the product to the cuticle.

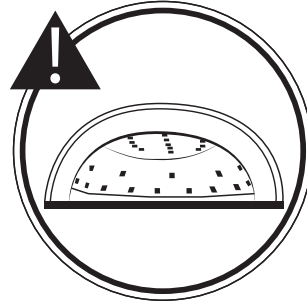

Use an inadequate lamp (e.g. minimum 30/36 diodes).

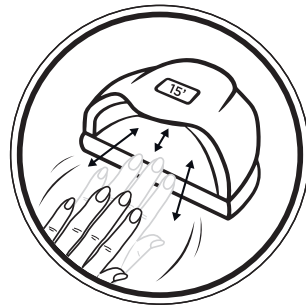

N.B. If the client feels a strong sensation of heat, move the hand in and out of the lamp 10 times over the course of each curing period.

Applying a builder gel - No filing technique

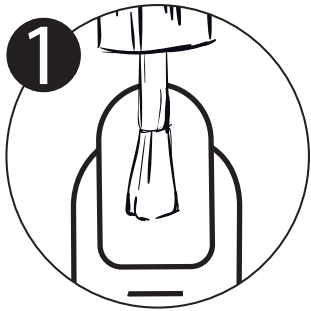

Apply a slip layer of **Gelnius** or **HD Fiber** to the nail. **Do not cure.**

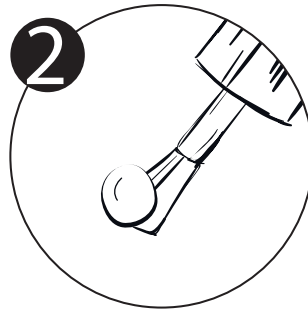

Take a bead of product.

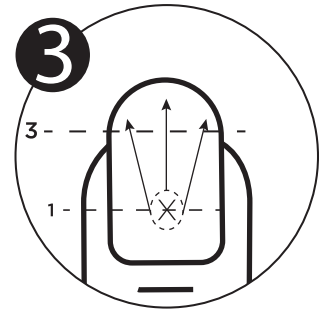

Create the **apex**: place the bead 1/3 of the way up the natural nail, push the product back towards the cuticle, then work the product out towards the length, without moving the apex of the nail.

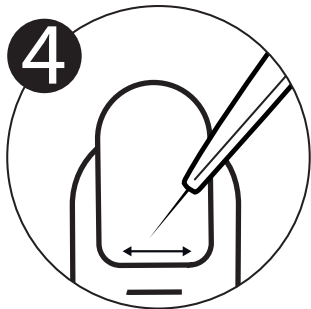

If necessary, define the structure and cuticle area using the **Trendy Brush Super Fine**.



Cure under a UV or UV/LED lamp for the time indicated in the product information.

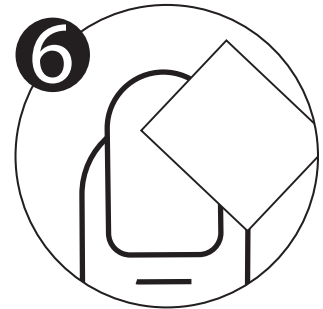

Vigorously **remove the tacky inhibition layer** using the **Cleaner**.

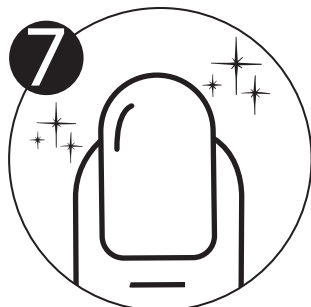

Proceed applying a **gel colour, gel polish or finish and cure**. Remove the inhibition layer from the top coat if needed.