



PÀSSIONEBEAUTY

PREPARATION, APPLICATION
AND REMOVAL OF STANDARD GEL POLISH
(WITHOUT A NAIL DRILL)



Preparation

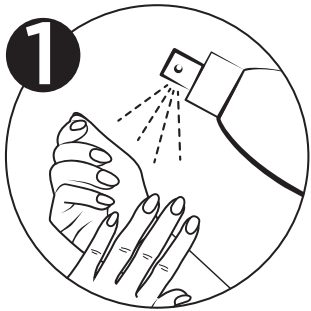

Spray **Fresh & Pure** onto hands and nails and allow to air dry.



Trim the free edge of the nail with a file.

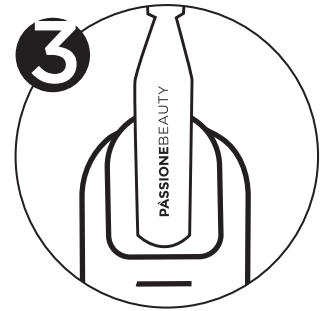

Gently push back the cuticles with the specially designed **Orangewood Sticks** or **Cuticle Pusher**.

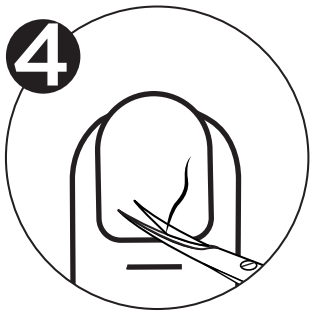

Remove cuticles with nail scissors.



Buff the surface of the natural nail using the **Preparation File Zebra Premium 180/240**.



Use **Nail Brush** to remove all dust from the surface.

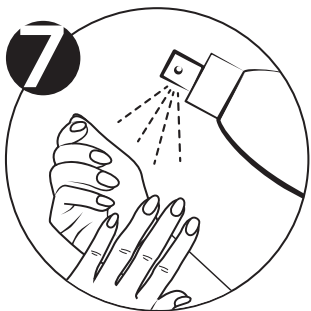

Spray **Fresh & Pure**.

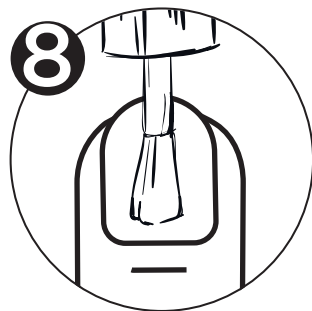

Apply **Nail Prep** and then **Binder** to the entire natural nail surface and allow to air dry.

NOTE. APPLY BINDER TO THE NATURAL NAIL ONLY, EVEN WHEN DOING REFILLS.

Applying a base coat

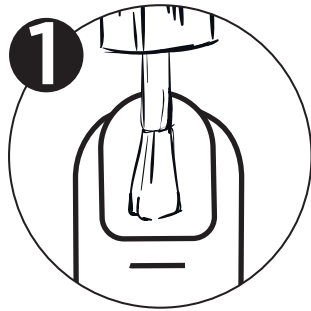

Spread an even layer of **Base coat** over the entire surface of the nail, taking care not to touch the cuticles.



Cure the product for **30 seconds** under a UV/LED lamp or **120 seconds** under a UV lamp.

WHAT NOT TO DO

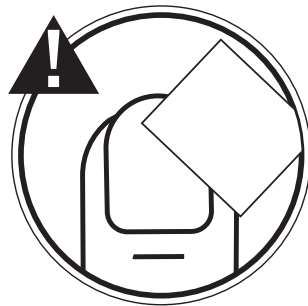

The tacky inhibition layer of the base coat should not be removed after curing.

Applying a coloured gel polish



Shake the bottle.



Take a **small amount** of product onto the brush, letting any excess to drain back into the bottle.

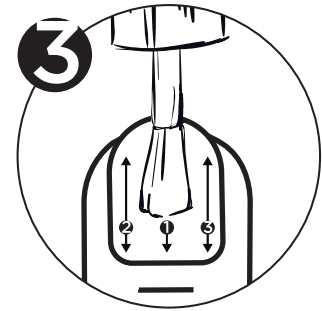

Apply a **thin layer** of polish, starting **from the centre** of the nail and working outwards **to the sides** and from the cuticle towards the free edge. You may see some imperfections on your first coat, but simply turning the hand upside down for a few seconds before putting it under the lamp will allow the gel polish to even itself out.



Cure under a UV LED lamp for **30 seconds**.

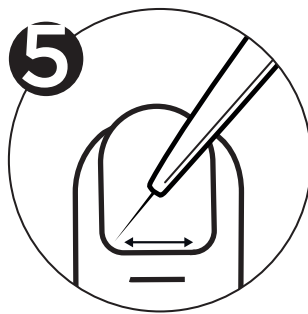

Apply a second thin layer of gel polish. Use **Trendy Brush Super Fine** to refine the application and be more precise around the cuticle area. This coat will achieve an evenly perfect coverage.



Cure under a UV LED lamp for **30/60 seconds**, depending on the instructions on the label or on the product information.

Applying a coloured gel polish

WHAT NOT TO DO

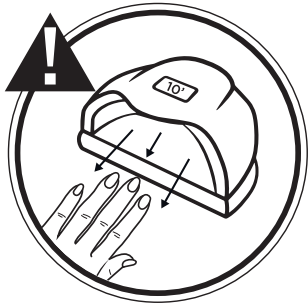

Do not remove the hand from the lamp before the end of curing time.



Do not move the hand 'in and out' of the lamp to set the gel polish.

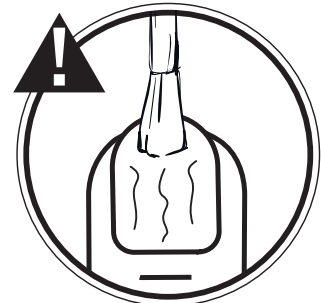

Do not apply too thick layers of gel polish as this can cause bubbling and unevenness on the surface.

Applying a topcoat



Apply a **thin and even layer of Gloss**, taking care to seal also the free edge of the nail.



Cure under a UV or UV/LED lamp for the time indicated on the label or on the product information.

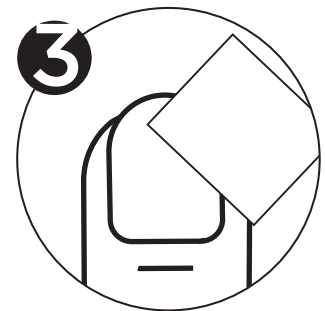

Remove any inhibition layer if needed.

NOTE: IF THE GEL POLISH OR THE BASE ONTO WHICH THE TOPCOAT IS APPLIED HAS A LOT OF TACKY LAYER, IT IS ADVISABLE TO REMOVE THE INHIBITION LAYER WITH CLEANER AND BUFF THE SURFACE OF THE NAIL.

Applying a top coat

WHAT NOT TO DO

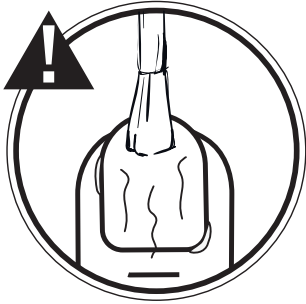

Do not apply too thick layers of top coat as it may dribble down onto the cuticle, with the possibility of creating liftings.



Avoid applying the product too thinly and ensure that the free edge of the nail is always sealed too.

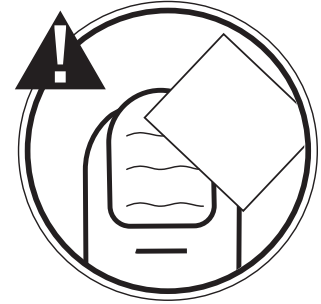

If applying a top coat with inhibition layer, always wait a few seconds before removing it.

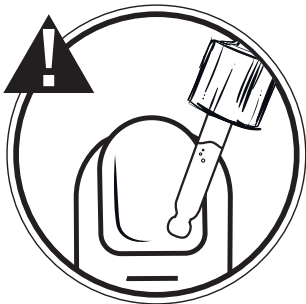

If applying a top coat without inhibition, wait at least 10 minutes before applying cuticle oil.

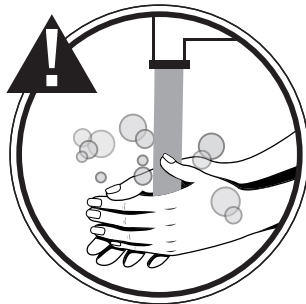

When applying top coats without tacky layer we recommend having the client wash their hands before applying cuticle oil.

Soak-off removal

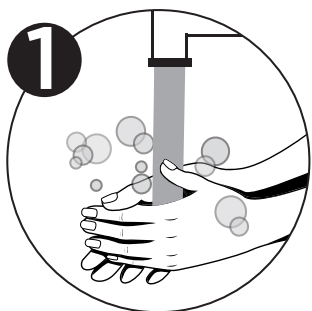

Wash hands.



Spray **Fresh & Pure** onto the hands and nails and allow to air dry.



Buff the surface of the nail: use **Pink Halfmoon Buffer, White Buffer** or a fine grit file such as the **File Zebra Premium 100/180**.

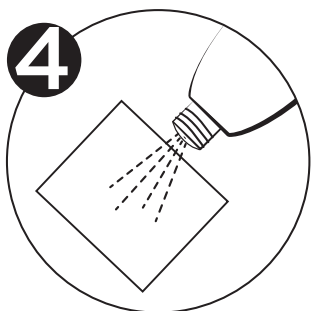

Place a pad soaked with plenty of **Remover** onto the nail.



Secure the pad with a **Soak-Off Remover Clip**.

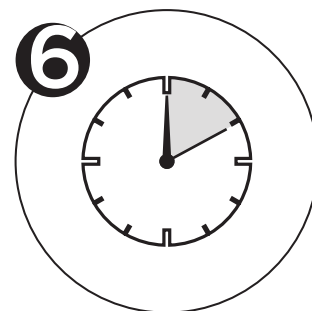

Wait around **ten minutes**, until the product has softened.

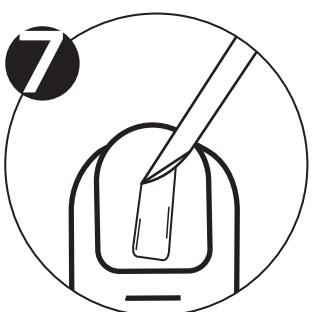

Finally, remove any residue using an **Orangewood Stick**.

NOTE. TIMINGS MAY VARY SLIGHTLY DEPENDING ON THE AMOUNT AND CHARACTERISTICS OF THE GEL POLISH APPLIED. DO NOT EXCEED 15 MINUTES OR THE PRODUCT MAY EVAPORATE.